



beLEDs
ENJOY LIFE IN COLOR

Q Station (QLight)

Quick Installation Guide

For Android

(Q Bulb)

(Support Android Version: 4.2 and above)

1. Installation

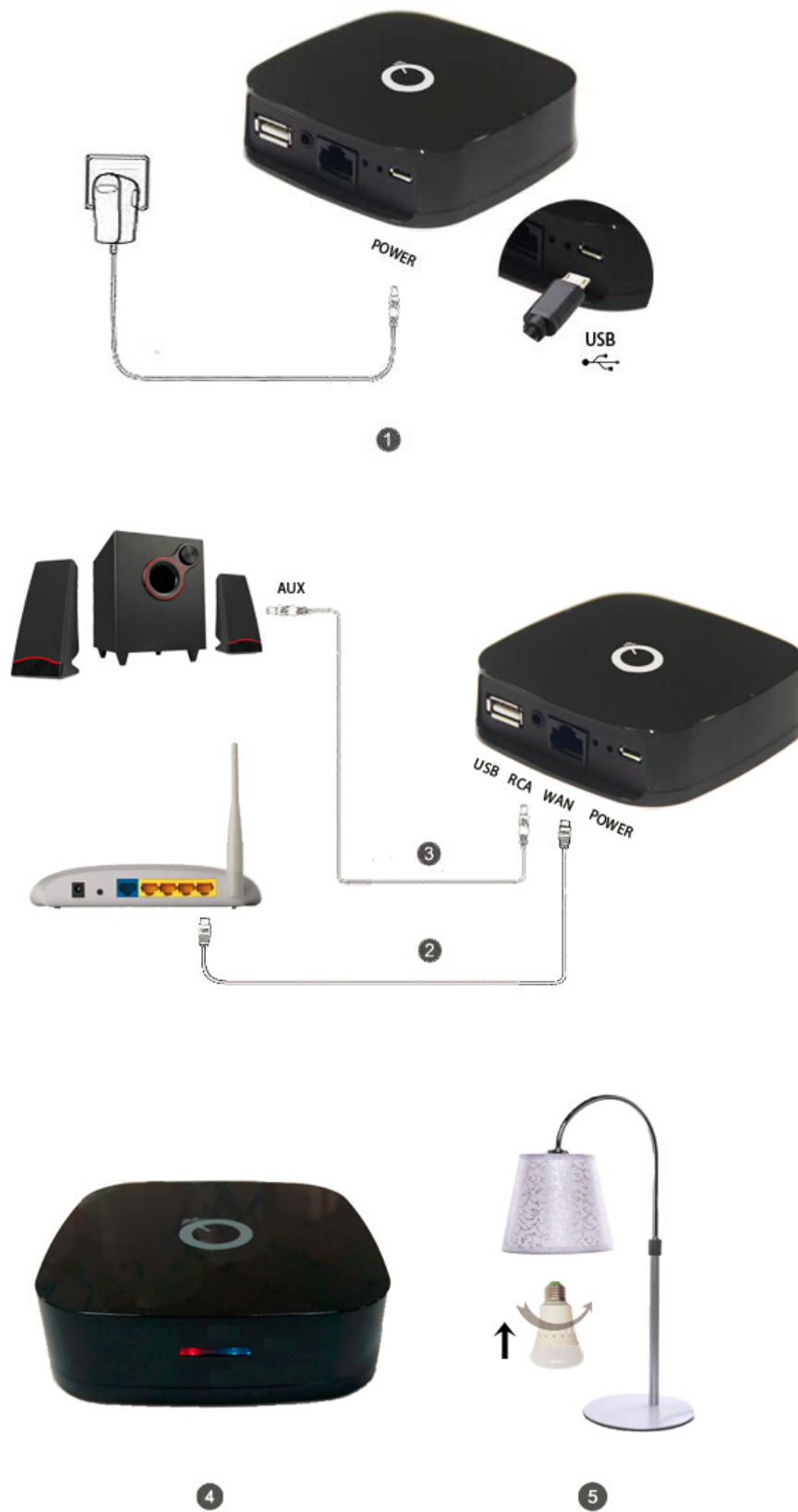

Figure 1: Power up Q Station

Installation Steps:

- 1) Plug in Power Adapter to Q Station.
- 2) Connect the Q Station to the LAN of your Home Router with LAN cable (optional).
(If you want to connect internet wirelessly, please refer to Q Station User Guide.)
- 3) Connect the Audio Cable from your Q Station to the AUX of your stereo or speaker.
- 4) Make sure the indicator light of Q Station is blinking with red (left) and blue (right).
- 5) Screw-in the Q Bulbs.

2. Connect your smart device to Wi-Fi

By changing your Wi-Fi connection to "bellnetXXXXXX", you will connect to the Q Station.

Notice:

- By default, Q Station SSID is "bellnetXXXXXX". No Encryption. (XXXXXX is the last 6 digit of your MAC)
- Once it is successfully connected to the Q Station, the right indicator light should be a steady blue color. Otherwise it will be blinking.

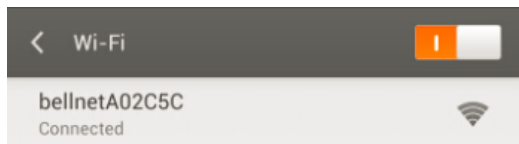

Figure 2: Connect Q Station SSID

3. Play music & Light show (use your smart phone)

- 1) Install any music APP which supports DLNA protocol (e.g. BubbleUPnP).
- 2) Run BubbleUpnp. (Figure 3)
- 3) Add one song in PLAYLIST.
- 4) In RENDERER, choose “bellmusicXXXXXX”. (Figure 4)
- 5) Click “Play” button to play music.

Notice:

- By default, Q Station Speaker Name is “bellmusicXXXXXX”.(XXXXXX is the last 6 digit of your MAC)
- DLNA protocol allows you to stream music to the stereo or speaker which is connected to the Q Station. And the Q Bulbs will blink synchronously with your music.

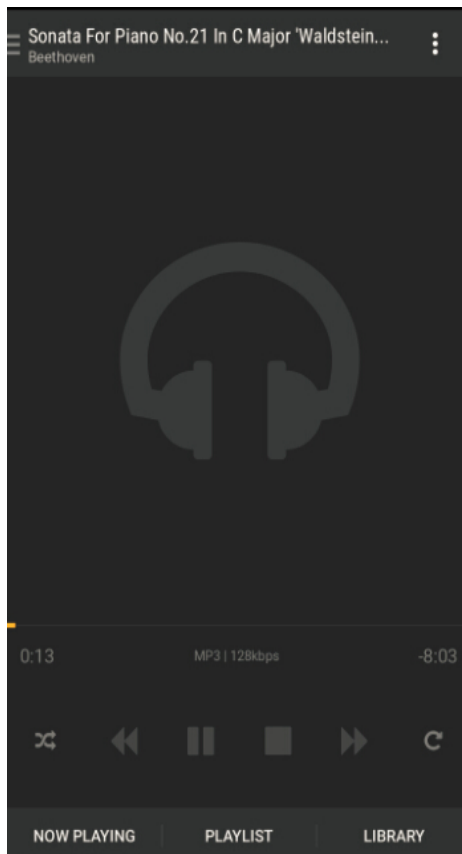

Figure 3: Use BubbleUPnP to play music

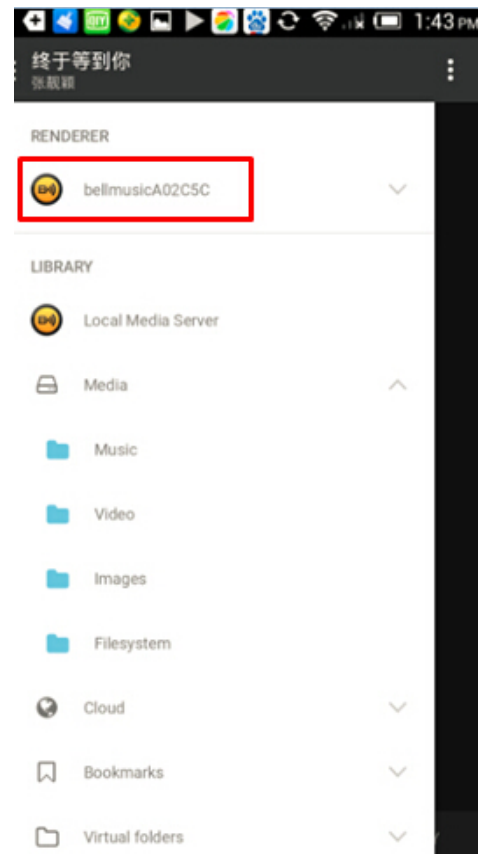

Figure 4: RENDERER choose:
“bellmusicXXXXXX” (e.g bellmusicA02C5C)

4. Lighting Control

Install BellQ

- 1) Search the APP “**QLight**” in Google Play. Download and install it.
- 2) Run it. You'll see light control page. (Figure 5, Figure 6)

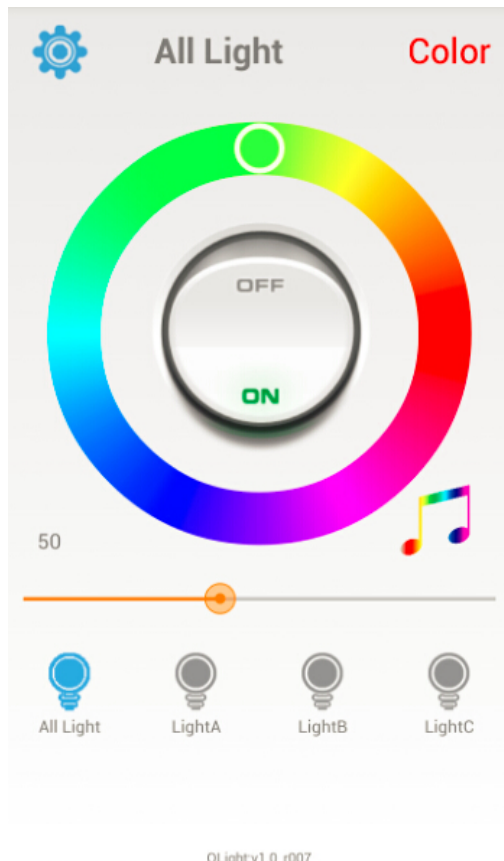

Figure 5: Color Mode

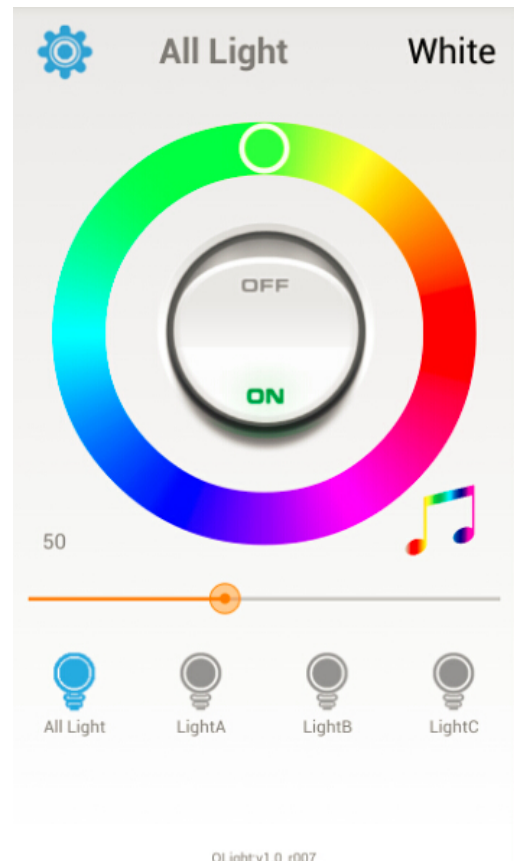





Figure 6: White Mode

Click “ALL”: all your light control operation will control all three Q Bulbs.

Light Control:

- 1) Click ON or OFF to turn on or turn off the Q Bulbs.
- 2) Slide the little circle  to adjust the color of light.
- 3) Move the intensity bar  to adjust the brightness.
- 4) Click “Color” / “White” to control the light mode.

Click “LIGHT A”/ “LIGHT B”/ “LIGHT C”: You can control the light separately.

Click : You can control whether the lights blink with music or not.

5. Network Configuration.

Click  to enter Network Page.

Set password for your Q Station SSID

Click **Basic Settings** to modify the Q Station SSID & Password.

Change your speaker name

Click **Music Service** to modify the Speaker Name.

Connect to internet wirelessly

Click **Internet Connection** to connect to other Wi-Fis.

(For more details, you can refer to Q Station User Guide from belleds.com.)